

# CONSTANT HEAT SEALER AIE-200CH, 300CH, 400CH INSTRUCTION

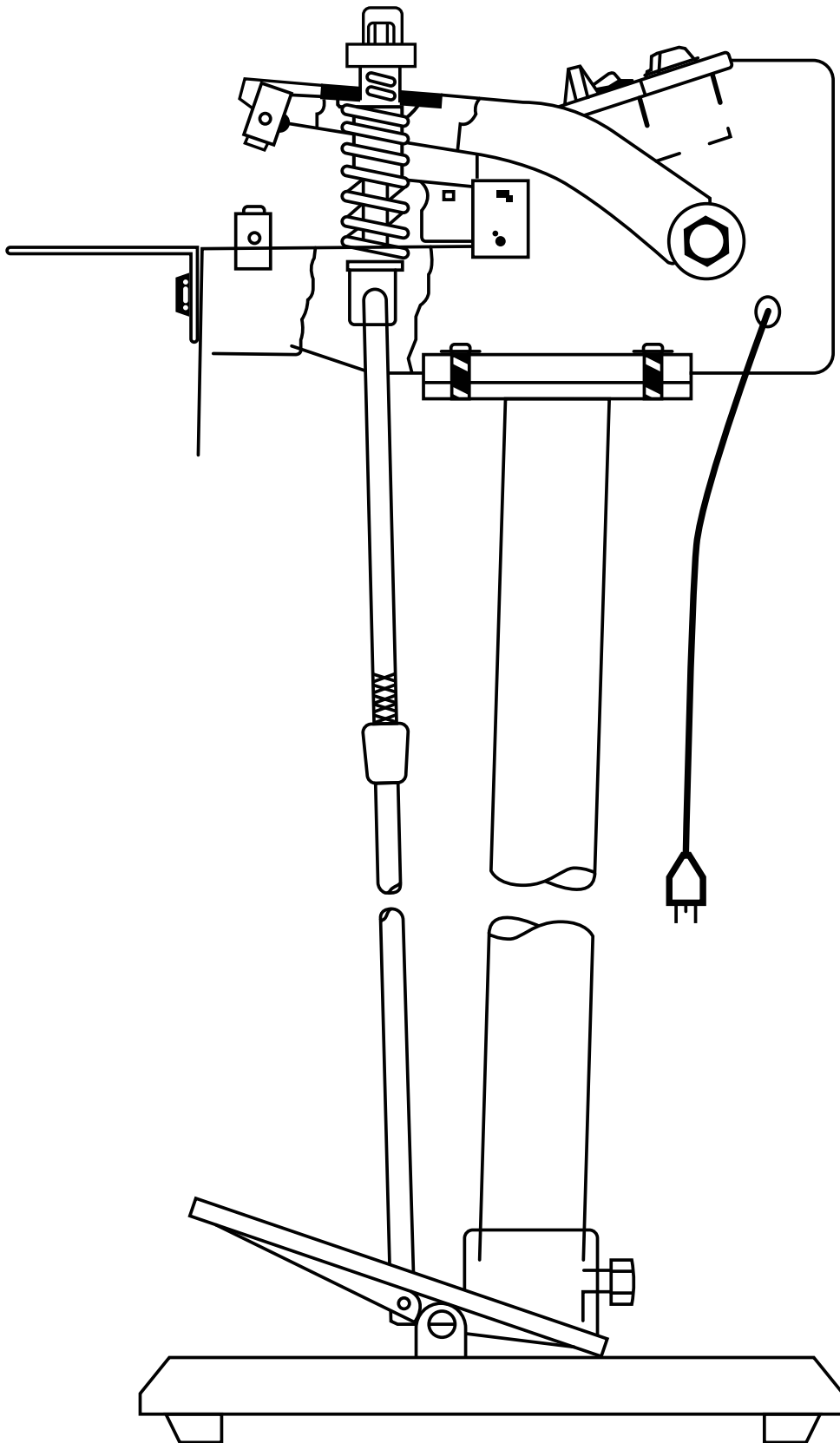

# 1 CONSTRUCTION DIAGRAM

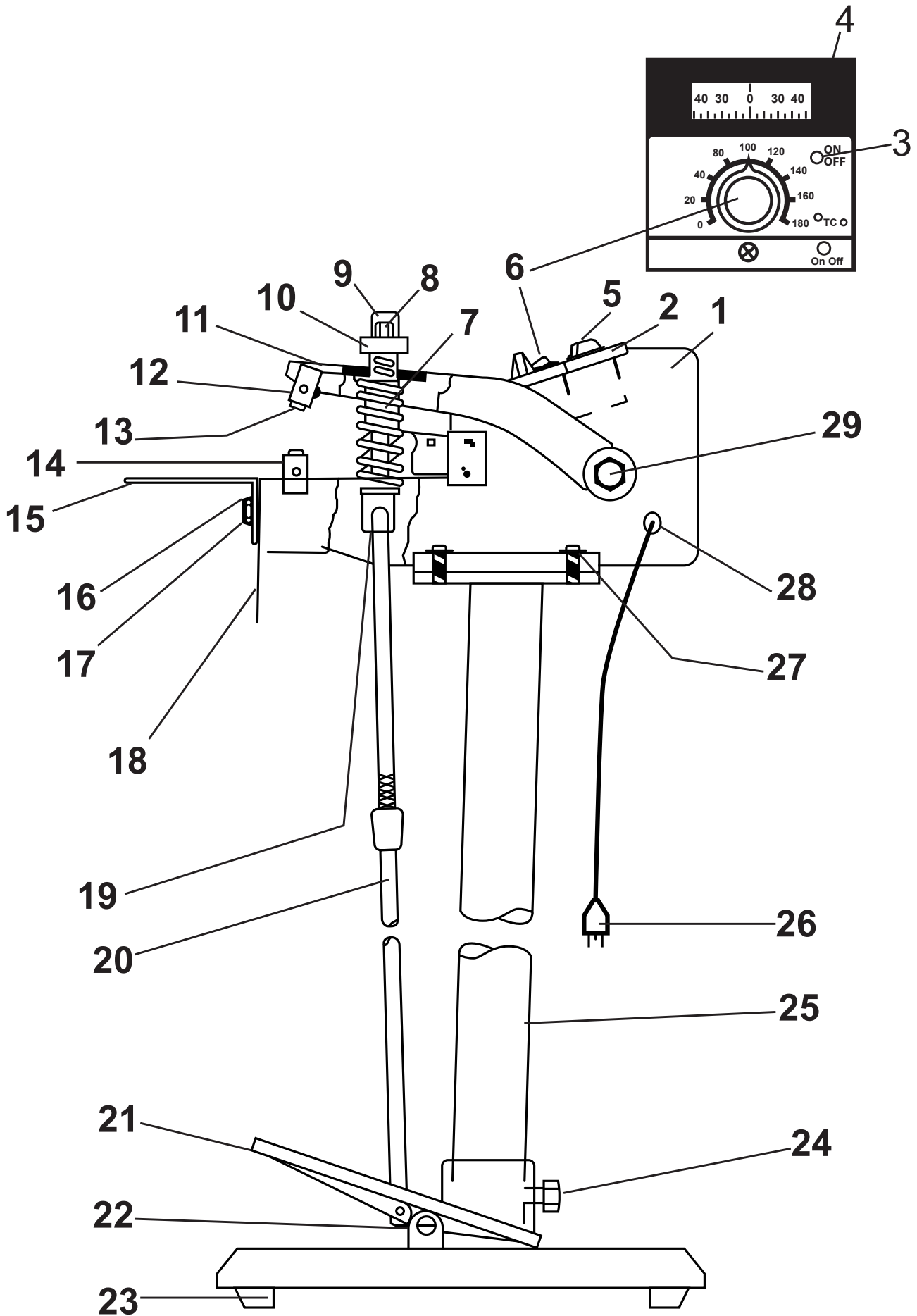

## 2 PARTS LIST

1. BODY
2. CONTROL PANEL
3. NEON LAMP
4. IL-70AD
5. ON I OFF SWITCH
6. TEMP. CONTROL KNOB
7. PRESSING SPRING
8. SETTING BOLT
9. PULLER CONNECTOR
10. PLATE
11. UPPER JAW
12. HEATING ELEMENT
13. HEATER SET
14. HEATING ELELEMENT
15. WORKING PLATE
16. HEATER SET
17. WORKING PLATE HOLD SCREW
18. LEVEL PLATE
19. UP LEVER
20. DOWN LEVER
21. FOOT BOARD
22. SCREWS FOR FOOT BOARD
23. RUBBER FOOT
24. SCREW FOR STANDING TUB
25. STANDING TUB
26. POWER CORD
27. SCREWS FOR BODY WITH STANDING TUB
28. BESETING FOR WIRE
29. SCREW FOR UPPER JAW

## 3 CONNECTION DIAGRAM

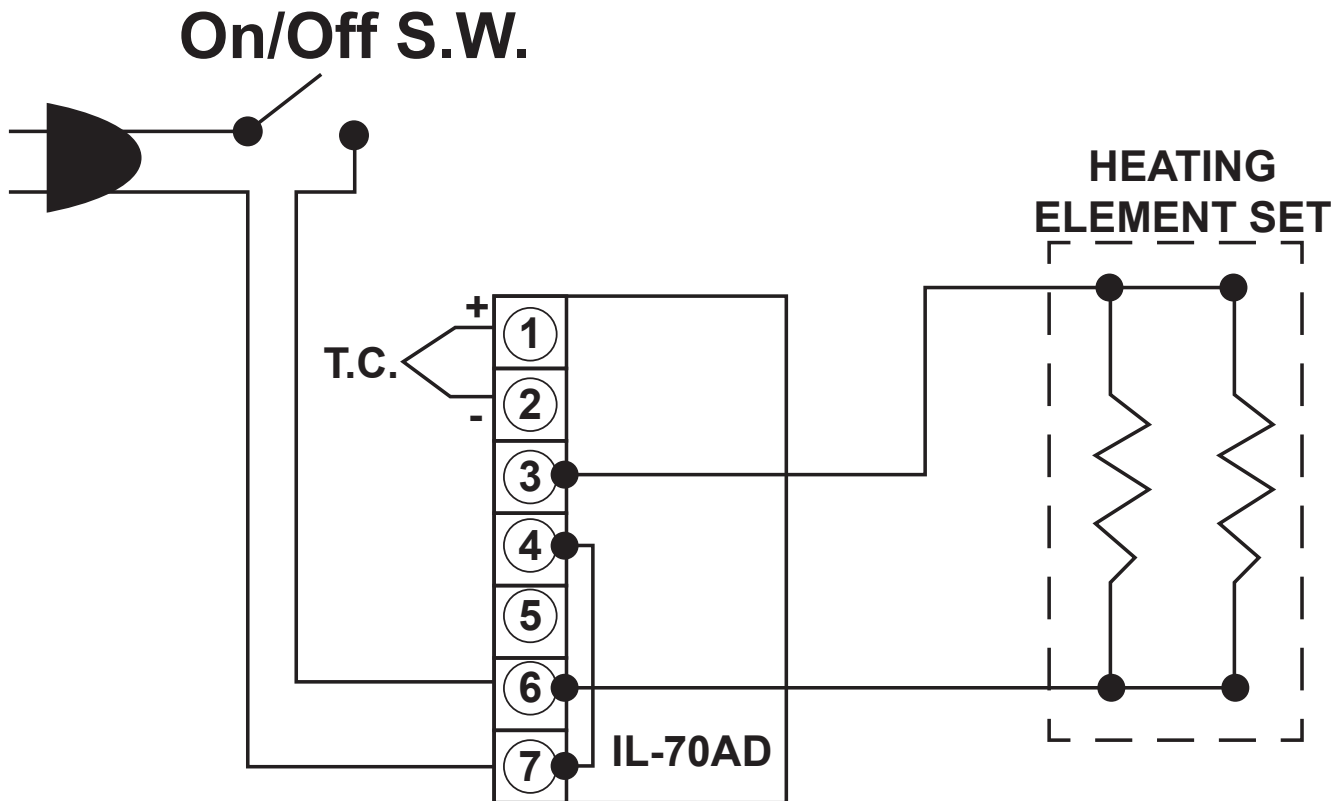

## 4 OPERATING INSTRUCTIONS

After the machine is fully assembled and plugged into a 120v AC outlet, do the following:

1. Adjust the foot pedal rod to obtain a firm contact of the jaws.
2. Turn the switch to ON. RED light will indicate that machine is ready to use.
3. Turn the temperature knob to the degree you want to seal at bag. The temperature will vary according to the type and density of the material to be sealed.
4. Timing of seal is determined by trial and error. It is suggested you start at a low temperature and increase the temperature until you reach a desired seal.
5. The GREEN jeweled light indicates that the machine is heating up. The RED light indicates that you have reached the selected temperature and you are ready to make a seal. It will take several minutes to heat up (IL-70AD).
6. The temperature controller is calibrated in centigrade. To convert to fahrenheit:  
$$T (0F) = [ T (0C) * 1.8 ] + 32$$
7. FOR SAFETY !!! AVOID TOUCHING JAWS OR HEX NUTS WHEN MACHINE IS ON !!!

**TURN MACHINE OFF WHEN NOT IN USE.**

## 5 HELPFUL INFORMATION

- Always keep the sealing platform clean. Particular care should be taken to remove any residue from both sides of the heating set.
- Do not clean the sealing platform with anything wet.
- Occasionally check the condition both sides of the heating set. A poor sealing platform will effect the quality of your seal.

**USE ONLY GENUINE REPLACEMENT PARTS**



## 6 CHANGING PARTS

To replace burnt out heating element please follow these instructions:

REMOVE PLUG FROM ELECTRIC OUTLET.

Replacing heating element.

- a. Loosen screws from back side of heating set.
- b. Remove heater element from heating set.
- c. Put new heating element on heater set.
- d. Tighten heating element in the heater set. Connect wire and heating element with butt splice.

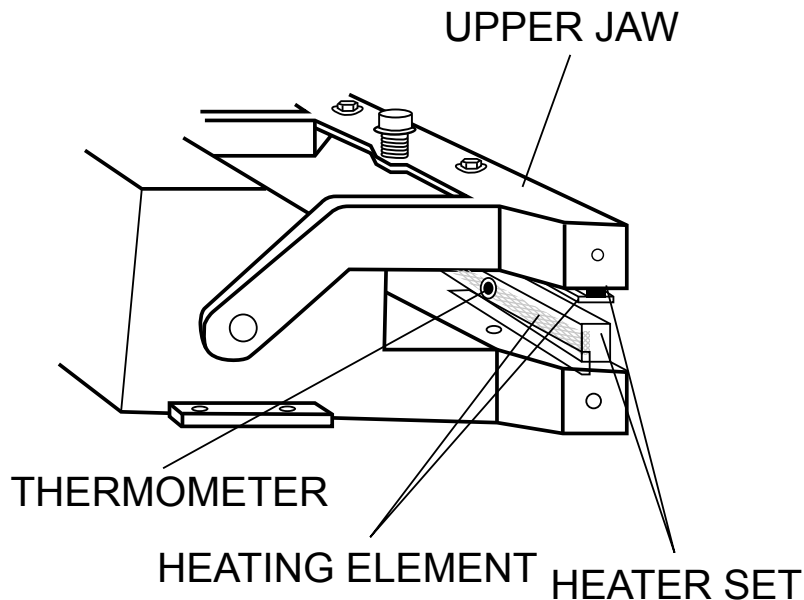

## 7 SPECIFICATIONS

	AIE-200CH	AIE-300CH	AIE-400CH
Max Seal	8 inch	12 inch	16 inch
Volts	125 V	125V	125V
Watts	250W	350W	420W
Weight	44 Lbs	48 Lbs	53 Lbs
Dimensions	17*17*29.5	17*17*29.5	17*17*29.5



## 8 ASSEMBLING FOR FOOT SEALER

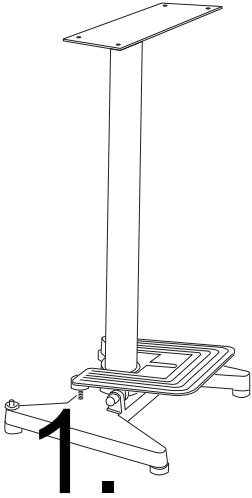

1. Insert STANDING TUBE into PEDAL BASE and connect with short screw.

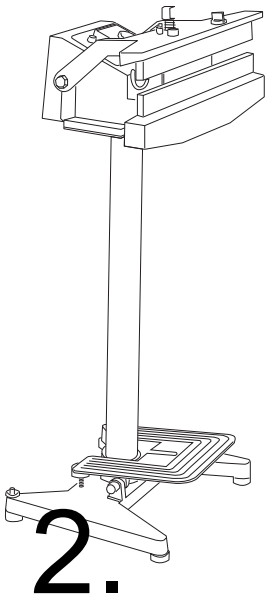

2. With four long screws. Connect BODY to STAND.

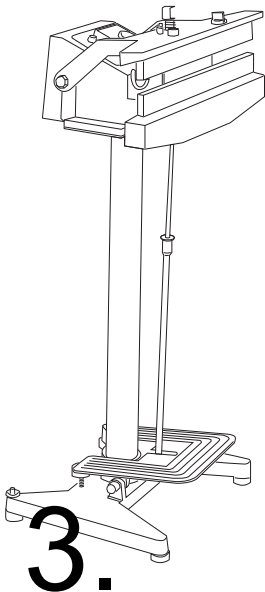

3. Attach PULLER ROD to PULLER (located under base) and then attach to FOOT PEDAL.

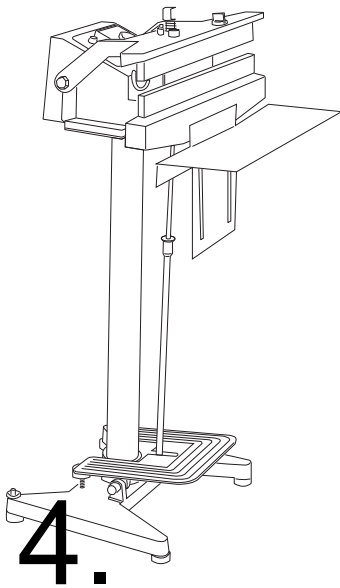

4. & (5). Connect WORKING PLATE FIXED BRACKET to BODY. Fit WORKING PLATE over Bracket.

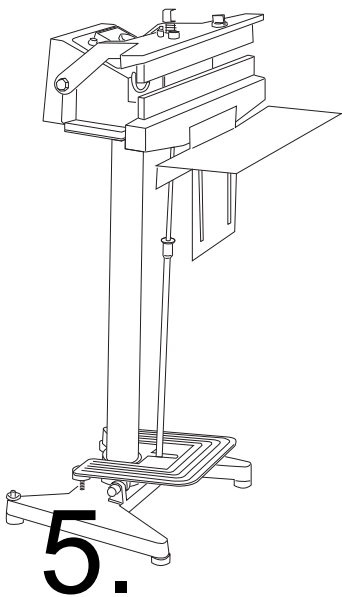

Note: When attaching working plate bracket, leave enough space between sealer body and top of screws so that working plate can be attached easily.

## ELECTRIC CONNECTION DIAGRAM

